



5TH COMMUNITY ENGAGEMENT SESSION



January 16, 2013

AGENDA

1. Timeline
2. Major Fact Finding Sources
3. Summary of Concerns
4. Review Facilities Options (1-7)
5. Criteria for Evaluating Options
6. Breakout Sessions
7. Next Steps

Ripon Area School District

Board core responsibilities guide facility solutions.

Facilities Master Planning

- Complete
- Technology Plan
 - Enrollment Projections
 - Mission & Vision
 - Team Selection
 - Initial Security Review

Facility Assessment and Solution Timeline

2013					2014					
Aug	Sept	Oct	Nov	Dec	Jan	Feb	Mar	Apr	May	Jun

- Physical Plant Condition Assessment
- Existing Capacity Analysis
- Supplemental Security Review

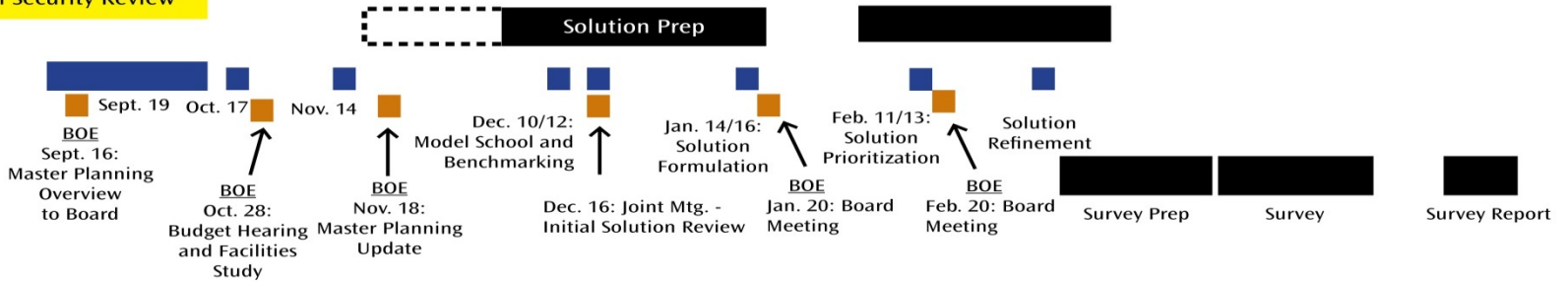

MAJOR FACT FINDING SOURCES

- Existing Facilities Survey
- Educational Space Analysis
- Teacher & Staff Survey
- Principal and Custodial Interviews
- Community Engagement Sessions

SUMMARY OF MIDDLE SCHOOL CONCERNS

1. Traffic Pattern
2. Lack of Playfields
3. Storm Water Drainage
4. Undersized Classrooms
5. Extensive Capital Maintenance List
6. Inconsistent Configuration of Classrooms
7. Difficult to Remodel *Hard Wall Construction
8. Various Floor Levels and Way Finding Issues



SUMMARY OF HIGH SCHOOL CONCERNS

1. Undersized Classrooms
2. Undersized Resource/Media Center
3. Improper Space for STEM Advanced Learning
4. Lack of Student-Centered Learning Spaces
5. Moderate Capital Maintenance List
6. Traffic Pattern
7. Security



DRAFT CONCEPT
OPTION 1

- **Continue Current Status - Small Maintenance Items (Barlow Park, Murray Park, Middle and High School)**
- **Minor Repairs Using Operational Budget**



DRAFT CONCEPT
OPTION 2

- **Ripon Middle School - Upgrades**
Water, Handicap Accessibility, Safety & Security
- **Larger Maintenance Systems – Upgrades**
- (Barlow Park, Murray Park, Middle and High School)
- **Little To No Remodeling**



DRAFT CONCEPT

OPTION 3A

Barlow Park Elementary - Maintenance & Safety Items
Murray Park Elementary – Maintenance & Safety Items
Ripon Middle School - Partial Replacement
Existing Site, West Facade
Ripon High School - Renovated



DRAFT CONCEPT OPTION 3A

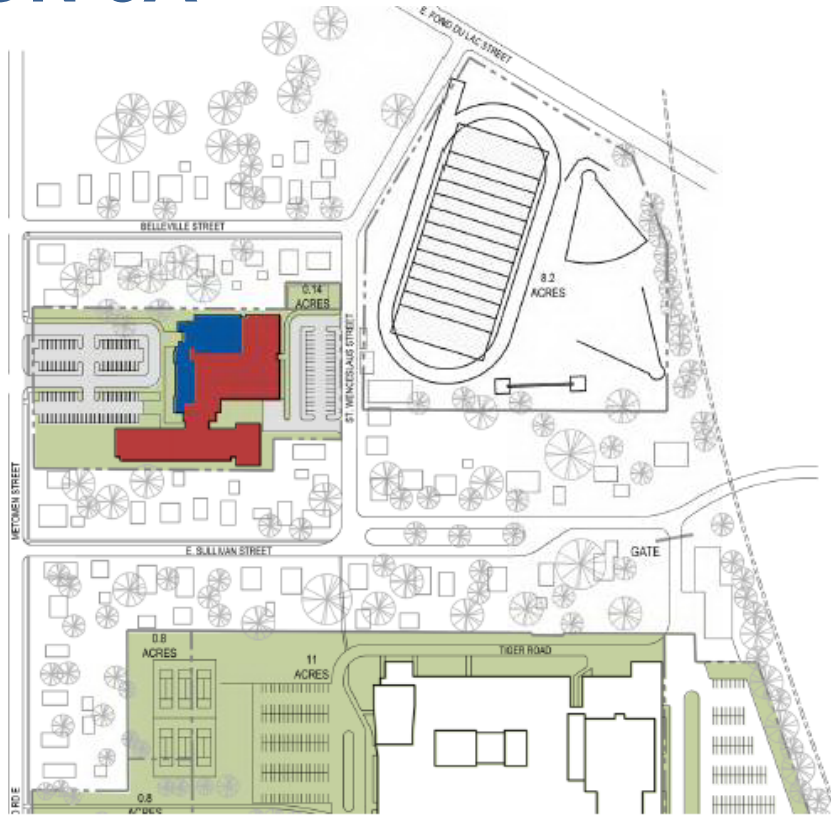

Option 3A

- Demolish portions of existing building.
- Construct new classrooms, administration and commons spaces.
- Renovate existing gymnasium and portion of existing classrooms.
- Regrade site to address storm water.
- Expand parking.

Second Floor

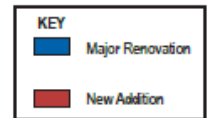
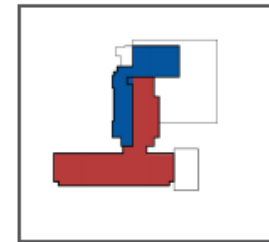

DRAFT CONCEPT

OPTION 3B

Barlow Park Elementary – Maintenance & Safety Items

Murray Park Elementary – Maintenance & Safety Items

Ripon Middle School - All New, Existing Site

Ripon High School - Renovated



DRAFT CONCEPT

OPTION 3B

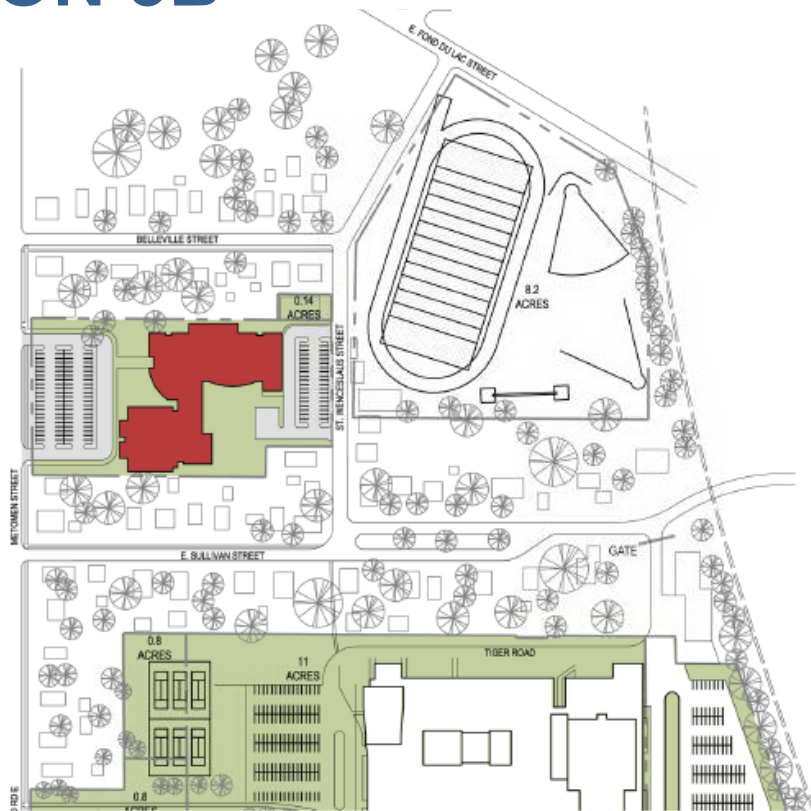

Option 3B

- Demolish existing middle school.
- Construct new middle school on existing site.
- Expand parking.
- Regrade site to address storm water.

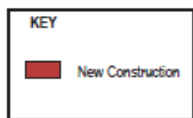

DRAFT CONCEPT

OPTION 3A & 3B

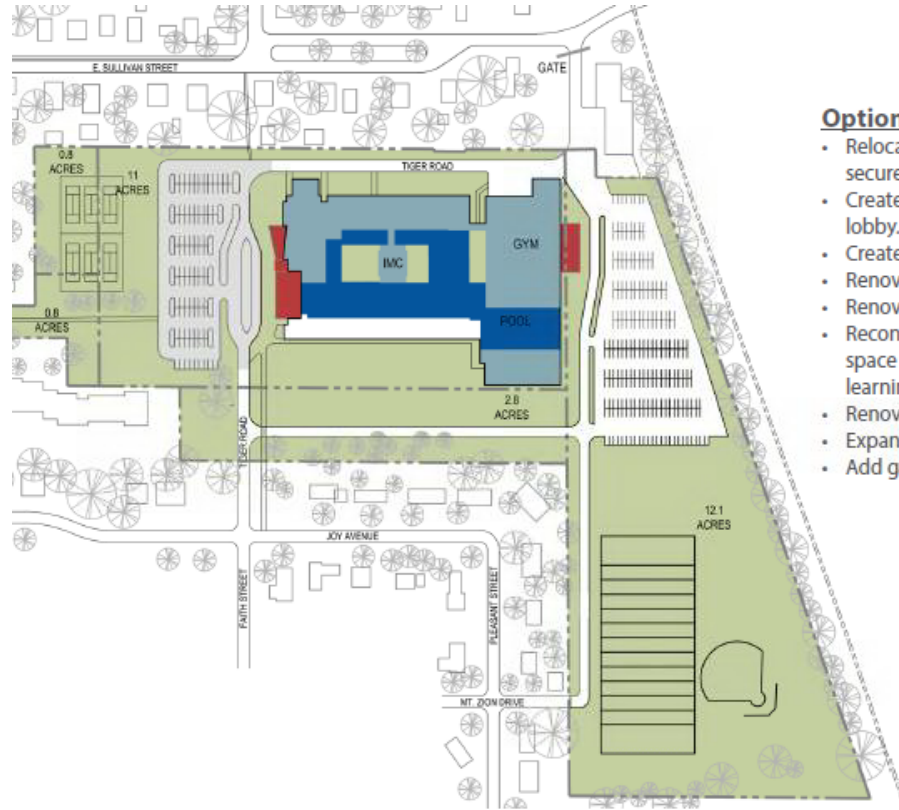

Option 3A & 3B

- Relocate administration office to new secure front entry.
- Create expanded auditorium/ public event/ lobby.
- Create new athletic events lobby entrance.
- Renovate science labs.
- Renovate library/ IMC.
- Reconfigure classroom wing to address space deficiencies and provide flexible learning spaces.
- Renovate pool to meet current standards.
- Expand parking
- Add gate at Sullivan St. Entrance.

KEY

- Minor Renovation
- Major Renovation
- New Addition

DRAFT CONCEPT
OPTION 4

Barlow Park Elementary - Maintenance & Safety Items
Murray Park Elementary – Maintenance & Safety Items
Ripon Middle School - All New, District Owned Land
Ripon High School - Renovated



DRAFT CONCEPT OPTION 4

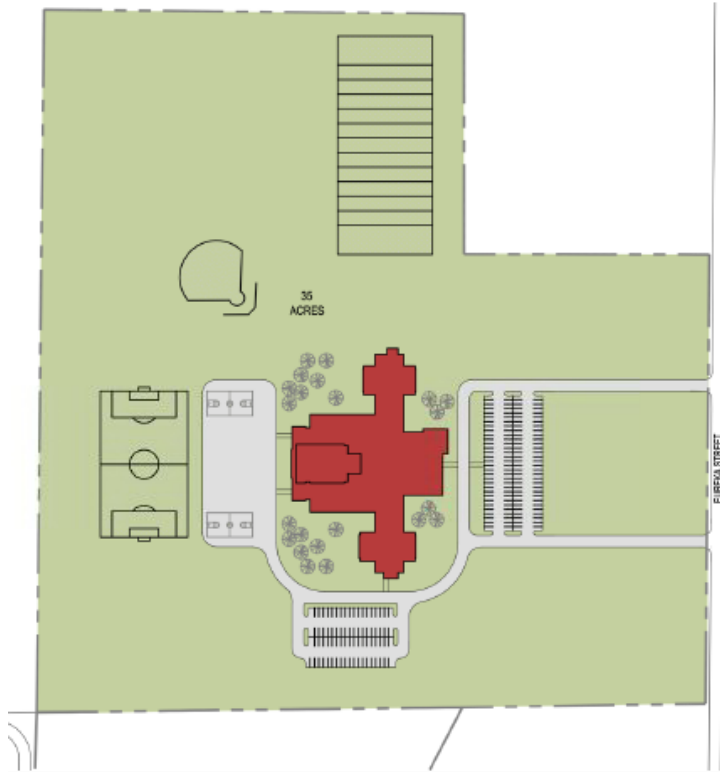

Option 4

- Construct a new single story middle school on district owned land.
- Extend utilities to site.
- Provide new athletic and play fields to support programming.
- Redevelop former middle school site.

Locker Rooms for High School and College Football
on Existing Middle School Site

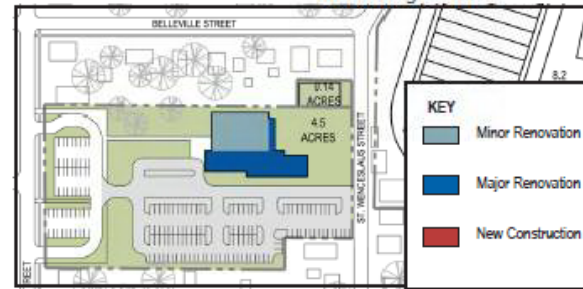

DRAFT CONCEPT OPTION 4

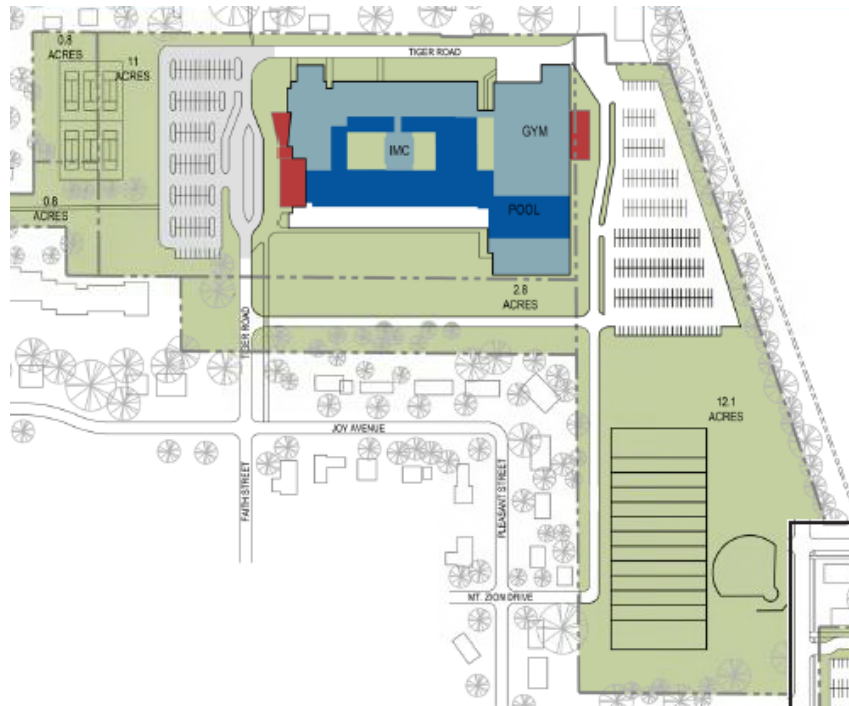

Option 4

- Relocate administration office to new secure front entry.
- Create expanded auditorium/ public event/ lobby.
- Create new athletic events lobby entrance.
- Renovate science labs.
- Renovate library/ IMC.
- Reconfigure classroom wing to address space deficiencies and provide flexible learning spaces.
- Renovate pool to meet current standards.
- Expand parking
- Add gate at Sullivan St. entrance.

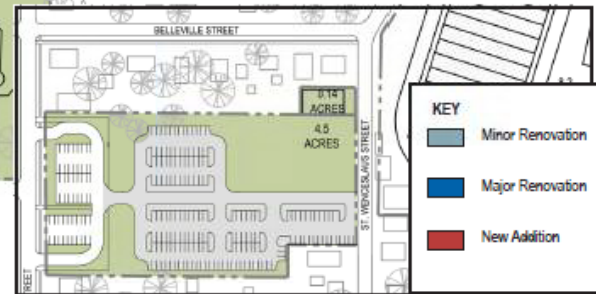

DRAFT CONCEPT
OPTION 5

- Barlow Park Elementary** – Maintenance & Safety Items
- Murray Park Elementary** - Maintenance & Safety Items
- Ripon Middle School** – Relocated to Expanded
High School Building
- Ripon High School** – Renovated



DRAFT CONCEPT OPTION 5

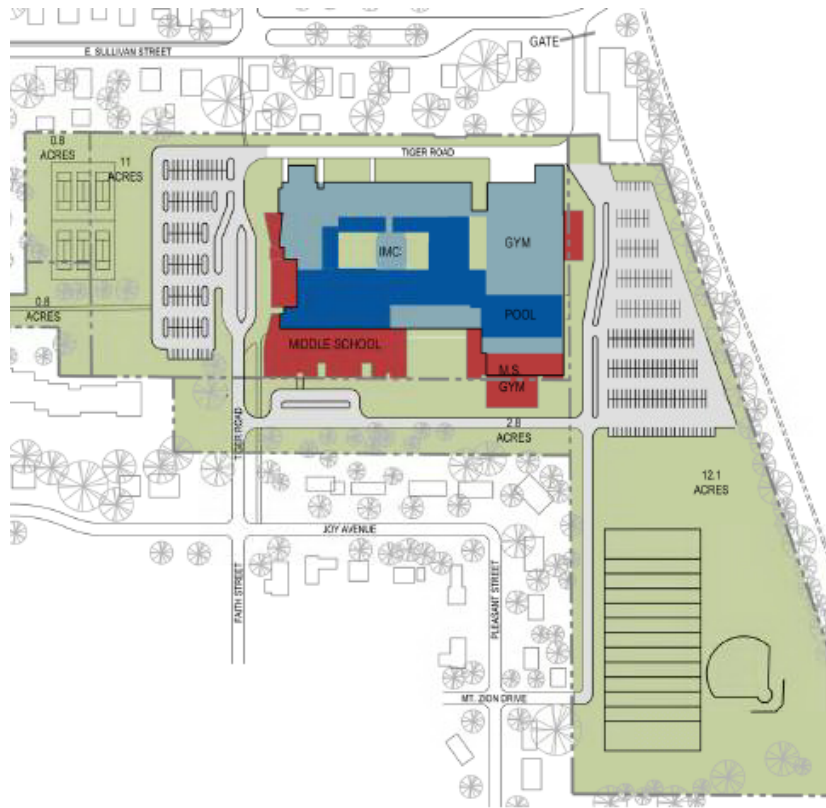

Option 5

- Relocate administration office to new secure front entry.
- Create expanded auditorium/ public event/ lobby.
- Create new athletic events lobby entrance.
- Renovate science labs.
- Renovate library/ IMC.
- Reconfigure classroom wing to address space deficiencies and provide flexible learning spaces.
- Renovate pool to meet current standards.
- Expand parking
- Add gate at Sullivan St. Entrance.
- Construct middle school addition to south.
- Provide middle school cafe/ commons.
- Construct additional two station gym.
- Redevelop former middle school site.

Locker Rooms for High School and College Football
on Existing Middle School Site

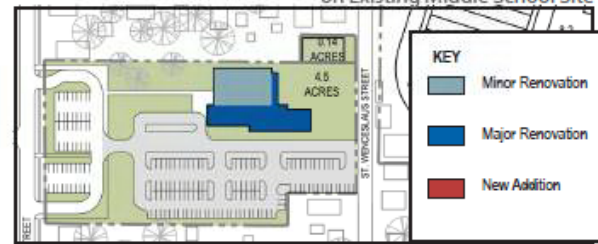

PROPOSED

OPTION 6

Barlow Park Elementary – Maintenance & Safety Items

Murray Park Elementary – Maintenance & Safety Items

Ripon Middle School – Relocated to Renovated High School

Ripon High School – New Building District Acquired Property



DRAFT CONCEPT OPTION 6

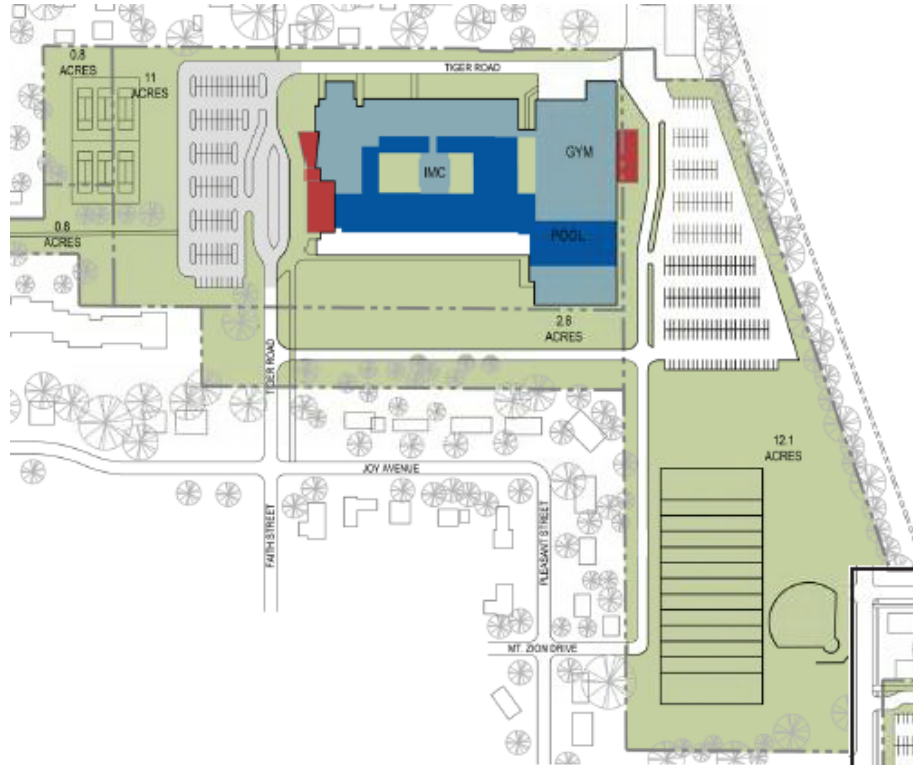

Option 6

- Relocate administration office to new secure front entry.
- Create expanded auditorium/ public event/ lobby.
- Create new athletic events lobby entrance.
- Renovate science labs.
- Renovate library/ IMC.
- Reconfigure classroom wing to address space deficiencies and provide flexible learning spaces.
- Renovate pool to meet current standards.
- Expand parking
- Add gate at Sullivan St. entrance.

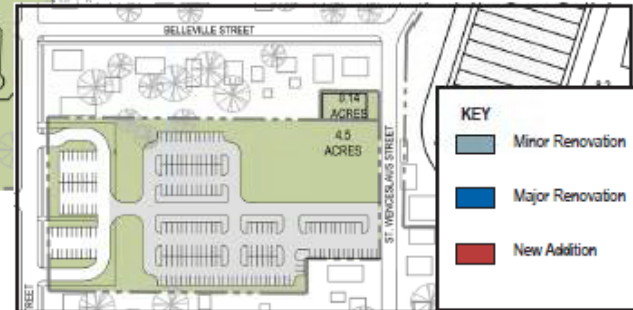

DRAFT CONCEPT OPTION 6

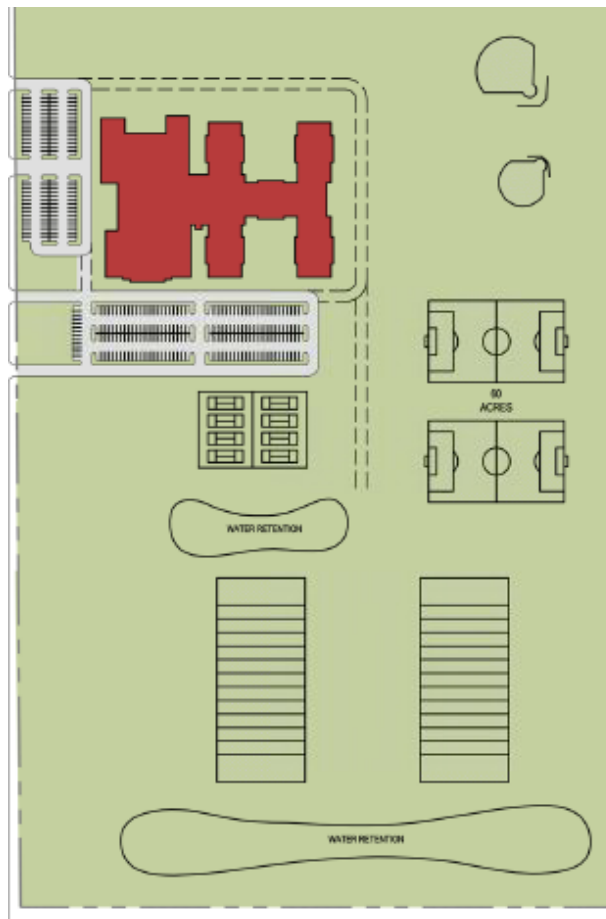

Option 6

- Develop new high school on new site.
- Relocate all high school athletic practice fields to new site.
- Extend utilities to site.

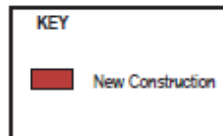

DRAFT CONCEPT
OPTION 7

Barlow Park Elementary – Maintenance & Safety Items

Murray Park Elementary – Maintenance & Safety Items

Ripon Middle School – Relocated New (6-12) Building District Acquired Property

Ripon High School – Relocated New (6-12) Building District Acquired Property



CRITERIA FOR EVALUATING OPTIONS

- Available Space Around MS & HS for Athletics
- Available Space Around MS & HS for Parking
- Parking for Ingall's Field
- Increased Space & Availability for Community Uses
- Pool Reconfiguration
- Long-Term Educational Needs
- Flexible Learning Spaces
- Improve High School Events/Function Spaces
- Improve Learning Environment (HVAC, Daylight, Technology)
- 5 Year Maintenance Needs
- Abatement
- ADA Accessibility
- Safety/Security, Traffic Flow & Parking
- Maximize Existing Space
- Energy Efficiency
- Pool Repairs
- Other?

CRITERIA MATRIX

January 16, 2014

Criteria for Evaluating Options	Option 1 No New Investment/ Operational Maintenance Only	Option 2 5 Year Capital Maintenance Safety & Security	Option 3A Option 2 Plus Remodel HS & MS	Option 3B Option 2 Plus All New MS in Current Location and Remodel HS	Option 4 Option 2 Plus All New MS on New Site(TBD) and Remodel HS	Option 5 Option 2 Plus Combined MS/HS at HS Site	Option 6 Option 2 Plus New HS on New Site and Use HS as MS	Option 7 Option 2 Plus New Combined HS and MS on New Site
Costs for Options In-Town vs Edge-of-Town Sites	FUTURE DISCUSSION - PLANNED FOR COMPREHENSIVE COMMUNITY INPUT							
Available Space Around Middle & High Schools for Athletics					✓		✓	✓
Available Space Around Middle & High Schools for Parking					✓	✓	✓	✓
Parking for Ingall's Field					✓	✓	✓	✓
Increased Space & Availability for Community Uses					✓	✓	✓	✓
Pool Reconfiguration			✓	✓	✓	✓	✓	✓(New)
Long-Term Educational Needs			✓	✓	✓	✓	✓	✓
Flexible Learning Spaces			✓	✓	✓	✓	✓	✓
Improve High School Events/Function Spaces			✓	✓	✓	✓	✓	✓
Improve Learning Environment (HVAC, Daylight, Technology)			✓	✓	✓	✓	✓	✓
5 Year Maintenance Needs		✓	✓	✓	✓	✓	✓	✓
Abatement		✓	✓	✓	✓	✓	✓	✓
ADA Accessibility		✓	✓	✓	✓	✓	✓	✓
Safety/Security, Traffic Flow & Parking		✓	✓	✓	✓	✓	✓	✓
Maximize Existing Space		✓	✓	✓		✓		
Energy Efficiency		✓	✓	✓	✓	✓	✓	✓
Pool Repairs		✓	✓	✓	✓	✓	NA	NA
Other?								
Other?								

BREAKOUT SESSIONS

- Do Options Address Goals of the Facility Planning Process?
- Eliminate from Discussion:
 - Costs for Options
 - In-Town vs Edge-of-Town Sites
- Top 2 Pro's & Con's Exercise

NEXT STEPS

January

- Principal Meetings
- Jan 20: Board of Education (Review of Options; Survey Presentations)
- Jan 27: Board Workshop Session (Prioritize Options)

February

- Feb 10: Community Engagement Session
- Feb 17: Board of Education